

Kia K2700 II 2,7

Timing belt: Renewal interval

Timing gear marking

Main belt: Cylinder 1 in compression TDC. Markings by A, B and C align.

Belt tensioning:

Turn the crank very little in its direction of rotation, so that the camshaft mark is 2 teeth after the fixed mark by B. Loosen the belt tensioner - and retighten - first at long slot.

Control:

Turn the crank back again until markings align.

Under pressure with finger by D belt should give 4 - 5 mm.

Belt for balance shafts:

Cylinder 1 in compression TDC, markings by A, E and F align.

Belt tensioning:

Push by H. Loosen the belt tensioner - and retighten (lower nut first).

Control:

With pressure applied (by hand) at G the belt should give 4 - 5 mm. (When dismantling balance shaft pulleys keep the shafts in place with bolt/ screwdriver at I and J).

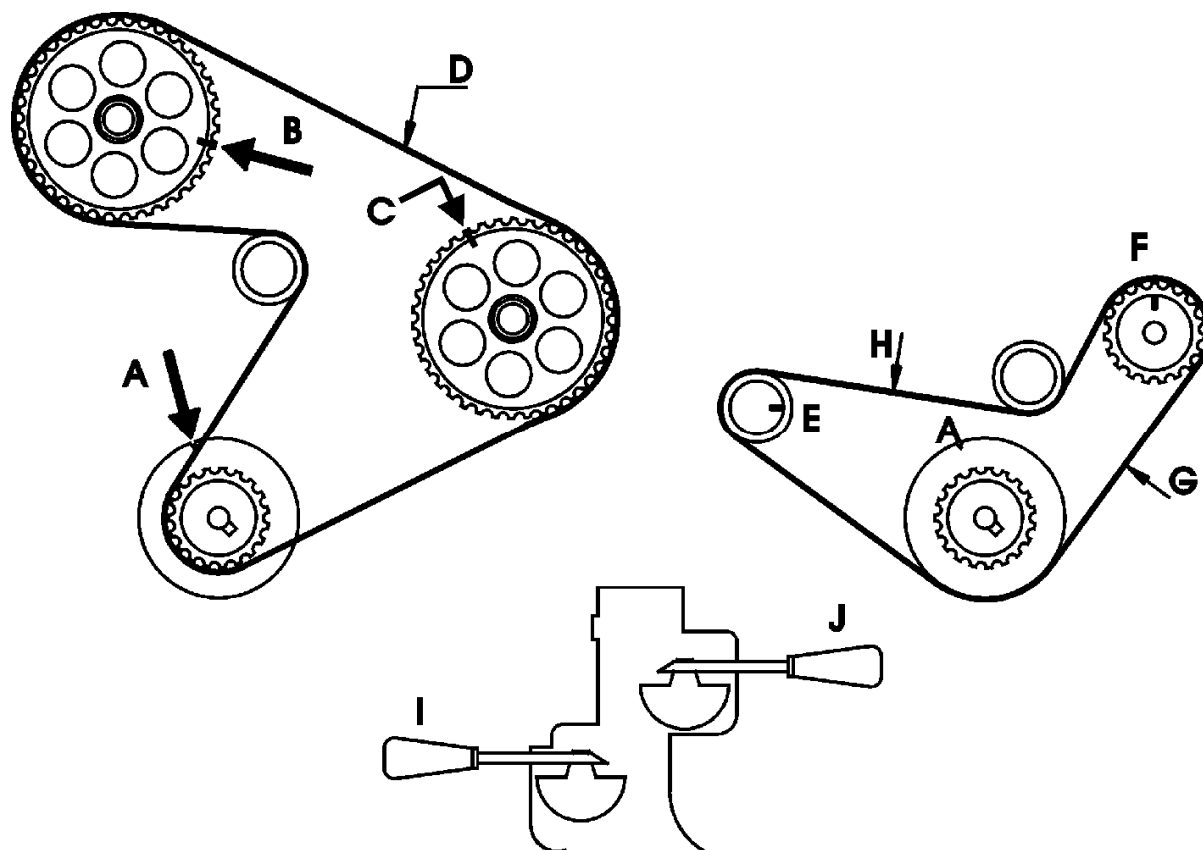

Pic. 1